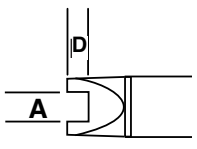

SMTC Rework Cartridges

Test Equipment Depot - 800.517.8431 - 99 Washington Street Melrose, MA 02176 - TestEquipmentDepot.com

SMTC REWORK CARTRIDGES

Compatible with: MX-500, MX-5000 and MX-5200 Systems / MX-RM3E and MX-H1-AV hand-pieces
All dimensions shown are in mm (inches)

SLOT		A	D	B	SMT TYPE
		SMTC-505 SMTC-005 SMTC-105	1.7 (.068)	1.27 (.05)	2.5 (.10)
SMTC-596 SMTC-096 SMTC-196	1.78 (.070)	1.02 (.040)	1.02 (.040)	Chip 0402, 0603	
SMTC-588 SMTC-088 SMTC-188	2.03 (.080)	1.52 (.60)	1.27 (.050)	Chip 0402, 0603, 0805	
SMTC-501 SMTC-001 SMTC-101	2.3 (.090)	1.8 (.070)	1.3 (.050)	Chip 0805	
SMTC-502 SMTC-002 SMTC-102	3.6 (.14)	1.8 (.07)	1.5 (.06)	Chip 1206,1210	
SMTC-132	3.81 (.150)	2.54 (.10)	2.41 (.095)	Chip Box B EIA SOPM-3528	
SMTC-536 SMTC-036 SMTC-136	4.8 (.190)	4.06 (.16)	2.8 (.110)	Chip Box B EIA SOPM-4532	
SMTC-503 SMTC-003 SMTC-103	4.83 (.190)	1.91 (.075)	2.03 (.080)	Chip 1812	

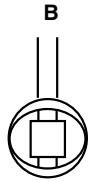

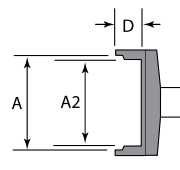
TUNNEL		A	A2	D	B	SMT TYPE
		SMTC-004 SMTC-104	5.08 (.20)	5.08 (.20)	2.3 (.90)	4.32 (.17)
SMTC-006 SMTC-106	5.08 (.20)	5.08 (.20)	2.3 (.90)	10.16 (.40)	SOIC-14, 16	
SMTC-0142 SMTC-1142	5.18 (.204)	5.18 (.204)	2.54 (.100)	8.89 (.350)	SOIC-14	
SMTC-047 SMTC-147	8.51 (.335)	8.51 (.335)	5.08 (.200)	6.35 (.250)	DPAC	
SMTC-126	8.64 (.340)	8.0 (.315)	1.88 (.074)	18.8 (.740)	SOJ-28, SOM-32	
SMTC-007 SMTC-107	9.53 (.375)	9.53 (.375)	3.20 (.125)	18.3 (.720)	SOIC-28	
SMTC-009 SMTC-109	9.53 (.375)	9.53 (.375)	3.18 (.125)	15.75 (.620)	SOIC-24	
SMTC-010 SMTC-110	9.53 (.375)	9.53 (.375)	3.20 (.125)	13.20 (.520)	SOIC-20	
SMTC-040 SMTC-140	11.43 (.450)	10.40 (.410)	1.90 (.075)	25.9 (1.02)	SOJ-40, SOM-32	

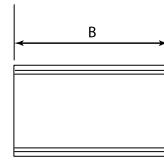

5 = 500 Series & 0 = 600 Series for temperature sensitive applications. 1 = 700 Series for most standard applications.

SMTC Rework Cartridges

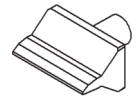

SMTC REWORK CARTRIDGES

Compatible with: MX-500, MX-5000 and MX-5200 Systems / MX-RM3E and MX-H1-AV hand-pieces. All dimensions shown are in mm (inches)

QUAD	SMT TYPE	A	A2	D	B	B2	SMT TYPE	BLADE TYPE
		(.330)	(.330)	(.100)	(.330)	(.330)		
	SMTC-0121	8.38	8.38	2.54	8.38	8.38	SQFP 48	Short
	SMTC-1121	(.330)	(.330)	(.100)	(.330)	(.330)	(EIJA)	
	SMTC-0112	10.16	9.14	3.80	10.16	9.14	PLCC 20	Long
	SMTC-1112	(.400)	(.360)	(.150)	(.400)	(.360)		
	SMTC-0120	11.18	11.18	2.54	11.18	11.18	SQFP 64	Long
	SMTC-1120	(.440)	(.440)	(.100)	(.440)	(.440)		
	SMTC-1159	12.19	11.18	2.79	13.21	12.19	TQFP 44	Long
	SMTC-013	12.70	11.56	3.80	12.70	11.56	PLCC 28	
	SMTC-113	(.500)	(.455)	(.150)	(.500)	(.455)		
	SMTC-116	12.70	11.43	3.80	15.24	13.97	PLCC 32	Long
	SMTC-1132	13.34	12.32	2.79	13.34	12.32	TQFP 80	
	SMTC-0118	15.49	14.48	2.79	15.49	14.48	VQFP 100	Long
	SMTC-1118	(.610)	(.570)	(.110)	(.610)	(.570)		
	SMTC-043	16.51	16.51	3.30	22.48	22.48	QFP 100	Short
SMTC-143	(.650)	(.650)	(.130)	(.885)	(.885)	Rectangular		
SMTC-014	17.78	16.76	3.80	17.78	16.76	PLCC 44	Short	
SMTC-114	(.700)	(.660)	(.150)	(.700)	(.660)			
SMTC-117	20.32	19.30	3.80	20.32	19.30	PLCC 52	Short	
SMTC-118	25.27	19.30	3.80	25.27	19.30	PLCC 68		
SMTC-144	26.42	26.42	3.30	26.42	26.42	QFP 100	Square	
HOOF	SMTC-5175	60°		.45°		11.43mm		SMTC-5175 SMTC-0175 SMTC-1175 SMTC-8175
	SMTC-5174	60°		.045°		1.14mm		
	SMTC-0174	60°		.65°		16.51mm		
	SMTC-1174	60°		.65°		16.51mm		
	SMTC-8174	60°		.65°		16.51mm		
	SMTC-0167	30°		.06"		1.52mm		SMTC-0167 SMTC-1167
	SMTC-1167	30°		.06"		1.52mm		
	SMTC-0169	60°		.08"		2.03mm		SMTC-0169 SMTC-1169
SMTC-1169	60°		.08"		2.03mm			
SMTC-0183	60°		.064"		16.36mm		SMTC-0183 SMTC-1183 SMTC-8183	
SMTC-1183	60°		.064"		16.36mm			
SMTC-8183	60°		.064"		16.36mm			
SMTC-0170	60°		.12"		3.05mm		SMTC-0170 SMTC-1170	
SMTC-1170	60°		.12"		3.05mm			
SMTC-5147	60°		.13"		3.3mm		SMTC-5147 SMTC-0147 SMTC-1147 SMTC-8147	
SMTC-0147	60°		.70"		17.78mm			
SMTC-1147	60°		.70"		17.78mm			
SMTC-8147	60°		.70"		17.78mm			
HOOK & CONICAL	SMTC-5172	30°		.02"		.51mm		SMTC-5172 SMTC-0172 SMTC-1172 SMTC-8172
	SMTC-0172	30°		.02"		.51mm		
	SMTC-1172	30°		.02"		.51mm		
	SMTC-5171	30°		.03"		.76mm		SMTC-5171 SMTC-0171 SMTC-1171 SMTC-8171
	SMTC-0171	30°		.03"		.76mm		
	SMTC-1171	30°		.03"		.76mm		
SMTC-5161	45°		.19"		4.83mm		SMTC-5161 SMTC-0161 SMTC-1161	
SMTC-0161	45°		.19"		4.83mm			
SMTC-5173	45°		.19"		4.83mm		SMTC-5173 SMTC-1173 SMTC-8173	
SMTC-1173	45°		.19"		4.83mm			
SMTC-8173	45°		.19"		4.83mm			
STTC-1173P	45°		.19"		4.83mm		STTC-1173P STTC-8173P	
STTC-8173P	45°		.19"		4.83mm			
KNIFE	SMTC-5161	45°		.08"		2.03mm		SMTC-5161 SMTC-0161 SMTC-1161
	SMTC-0161	45°		.08"		2.03mm		
SMTC-5173	45°		.19"		4.83mm		SMTC-5173 SMTC-1173 SMTC-8173	
SMTC-1173	45°		.19"		4.83mm			
SMTC-8173	45°		.19"		4.83mm			
STTC-1173P	45°		.19"		4.83mm		STTC-1173P STTC-8173P	
STTC-8173P	45°		.19"		4.83mm			

5 = 500 Series & 0 = 600 Series for temperature sensitive applications. 1 = 700 Series for most standard applications.
8 = 800 Series for Ceramic and high thermal demand applications.