

Model 2143 Double Miniature Banana Jack

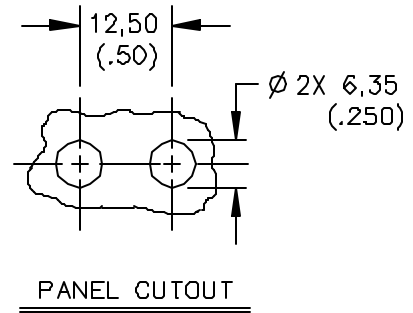
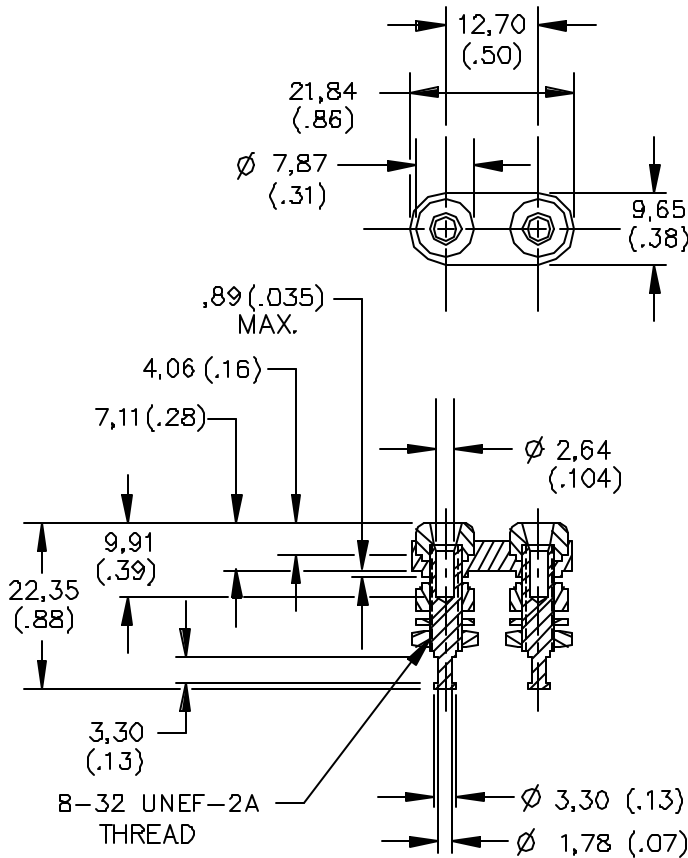

MODEL NO.	MTG. PLATE COLOR
2143-0	BLACK PLATE
2143-2	RED PLATE

FEATURES:

- Accepts miniature banana plugs.
- Mounts in panels up to .188" thick.

MATERIALS:

Banana Jack Insulation - Polycarbonate. Color: One Red and one Black.

Panel Insulator - Polycarbonate. Lockwasher #8 - Steel.

Hex Nut, #8-32 - Brass.

Banana Jack Body - Gold plated brass.

Finish:

Lockwasher #8 - Nickel plated.

Hex Nut, #8-32 - Nickel plated.

All dimensions are in inches. Tolerances (except noted): .xx = ±.02" (.51 mm), .xxx = ±.005" (.127 mm). All specifications are to the latest revisions. Specifications are subject to change without notice. Registered trademarks are the property of their respective companies. Made in USA

Banana Jack Body - Gold plated brass

RATINGS:

Operating Temperature: +115°C. (+239°F.) Max.

Operating Voltage: 1500 VRMS

Current: 5 Amperes

ORDERING INFORMATION: Model 2143-*

*=Standard Mounting Base Colors: -0 Black, -2 Red